

mFA Digital Directions 2023

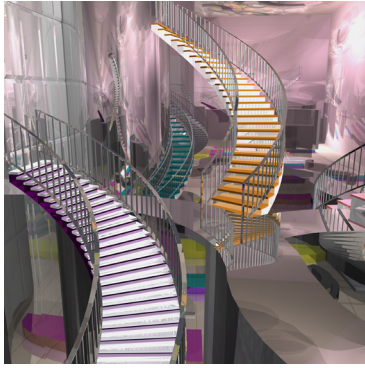

Silver Shadows Square, mixed media
Selena Nawrocki, from Digital Directions 2022

Computer software and technology have forever expanded the ways artists capture and produce their work. Artists can weave together scenes in photoshop, produce paintings through a screen, create videos, animations, and projections that transport us to new worlds, and sculpt with a 3D printer. Maryland Federation of Art (MFA) invites all artists residing in any of the states or territories of the US, Canada, or Mexico to enter our 3rd annual Digital Directions exhibition. Any original 2D or 3D image based work created and/or produced through digital software and following exhibition guidelines will be considered. This includes, but is not limited to digitally produced photography, digital painting, illustration, graphic design, digital video and projection. Works selected will be exhibited in MFA's Circle Gallery from February 1 – 25, 2023. Exhibition Chair: Emil Petruncio.

JUROR INFORMATION

Jeff Murphy is a Charlotte based artist working primarily with digital media. His creative career began while taking photography, film, and animation courses as an undergraduate at Ohio State University. Jeff's work has been published in a diverse array of publications, including WIRED magazine, World Art magazine, and the textbook Exploring Color Photography. He has received individual artist grants from the Arts and Science Council, the Ohio Arts Council, and the North Carolina Arts Council. In addition to over 40 national solo exhibitions, his digital images, videos, and installations have been seen in the US, Germany, Hungary, Spain, and Brazil. Jeff is currently an Associate Professor of Art at the University of North Carolina at Charlotte where he teaches digital imaging, interactive design, photography, video, and animation. He received his BFA from Ohio State University in 1989 and his MFA from University of Florida in 1995. See his work at murphydigitalart.com.

TERMS OF ENTRY

- Entry is open to artists residing in any of the states or territories of the US, Canada, and Mexico.
- Entering this exhibition indicates understanding and agreement on the part of the artist with the conditions stated herein and with (a) [MFA's approved Statement of Equity and Diversity](#) and (b) [MFA's General Guidelines](#). Work must meet exhibition guidelines to be included in the event. MFA may determine work ineligible if entry guidelines are not followed. Work delivered must correspond with the image(s) submitted to the juror.
- Images of accepted works may be used at the sole discretion of MFA for promotional purposes including, but not limited to: the invitation, catalog, website, social media, or a subsequent year's prospectus. Images will include attribution wherever possible.
- Work cannot be withdrawn before the end of the event.
- Artists will retain 70% from sales (75% for MFA Members). MFA will retain 30% commission (25% for MFA Members at the time of the sale) on any work sold through MFA.
- Work must be for sale. Work can be set to Price on Request (POR).

ENTRY REQUIREMENTS

- All work must be entered by uploading JPEG images through MFA's online entry system. Set pixel dimension to between 1,500 and 3,000 pixels on the longest side. File size may be no more than 5 MB. Images for the juror must correspond with the actual work. MFA does not display watermarks; artists display at their own risk. Visit mdfedart.com/portfolio/272/ to submit your work.
- For video submissions: upload a still frame from your video, and in the "media" section, put the media and then include a public YouTube or Vimeo link to the video. For accepted video work, the artist will be expected to deliver the file to MFA on a thumbdrive.
- All entries must be original and completed solely by the artist's hand. A maximum of 6 original works created within the past 3 years may be entered. Work previously exhibited at MFA Circle Gallery is not eligible for re-entry.
- Maximum size of work, including edges of artwork or frame, cannot exceed 72" in any direction. Artists may be asked to assist with the installation of oversized work (greater than 60" or over 40 lbs).

ENTRY FEE

- 1 or 2 entries \$40 (MFA Members \$25). Additional 4 entries \$5 each. Entry fees are non-refundable.

LIABILITY

- Artwork will be handled with all possible care. MFA will not be responsible or liable for loss or damage from any cause whatsoever. Insurance, if desired, must be carried by the artist.

NOTIFICATION

- All artists will receive notification by email. Accepted artists and artwork will also be posted on MFA's website.
- **Artists who have unsubscribed from MFA emails will not receive notification.**
- The notice to accepted artists will include specific details and may vary from prospectus. See website for more details.

AWARDS

- Cash awards total \$1,000.

SCHEDULE

Oct 5	Online Entry Opens for Submissions
Nov 23	Entry Deadline
Dec 20	Notification @ 5 PM
Jan 25 – 29	Accepted and Shipped Work Must Arrive at MFA Circle Gallery 11 AM – 4 PM
Feb 1	Exhibition Opens
Feb 5	Virtual Awards Ceremony @ 4 PM
Feb 25	Last Day of Exhibition; In-Person Reception at MFA Circle Gallery from 4 – 6 PM
Feb 26 – 27	Pick Up Hand-Delivered Work from 11 AM – 4 PM
Mar 2	Shipped Work Will Be Sent

MFA Circle Gallery Celebrating 59 Years

18 State Circle, Annapolis, MD | Open daily from 11 AM – 5 PM
410-268-4566 | info@mdfedart.org | mdfedart.org
MD Relay 7-1-1 or 1-800-735-2258
Circle Gallery is accessible to people with mobility disabilities

Established in 1963, MFA is a 501(c)(3) non-profit arts organization supported by individual, corporate, and public sector contributions, including the Maryland State Arts Council and the Anne Arundel County Arts Council. For membership and exhibition information, please visit mdfedart.org.